

TECHNICAL SPECIFICATIONS FOR MODEL EPH

INDOOR INDUSTRIAL/COMMERCIAL ELECTRIC PLENUM UNIT HEATER



Table of Contents

Unit Sizes	2
Features	2
Factory-Installed Options	2
Field-Installed Options	2
Technical Data	2
Dimensions	3
Weights	4

In keeping with our policy of continuous product improvement, we reserve the right to alter, at any time, the design, construction, dimensions, weights, etc., of equipment information shown here.

TECHNICAL SPECIFICATIONS—CONTINUED

Unit Sizes

These heaters are available in six unit sizes based on heating capacity of 3,000–15,000 watts.

Features

- Voltage/phase options: 208/1, 208/3, 240/1, 240/3, 277/1, 347/1, 480/1, 480/3, 600/1, 600/3
- Standard 24V control circuit
- 18- and 20-gauge steel cabinet with aluminum epoxy/polyester powder paint finish
- High-temperature limit control with automatic- and manual-reset
- Internal tamperproof single-stage thermostat—two-stage thermostat available for unit sizes 10, 12, and 15
- Direct-drive selectable-speed squirrel-cage fan (with delay) with totally-enclosed factory-lubricated motor
- Zero clearance for concealed space installation
- Horizontal or vertical mounting (for ducting) for unit sizes 3 and 5
- Optional pleated and washable filters and louvers available

Factory-Installed Options

Option	Description
AK2	Voltage/phase 208/1 (unit sizes 3, 5, and 7 only)
AK3E	Voltage/phase 240/1 (unit sizes 3, 5, 7, and 10 only)
AK4	Voltage/phase 277/1 (unit sizes 3, 5, 7, and 10 only)
AK5	Voltage/phase 208/3
AK6E	Voltage/phase 240/3
AK7E	Voltage/phase 480/3
AK8E	Voltage/phase 600/3
AK9E	Voltage/phase 480/1
AK10	Voltage/phase 600/1
AK34	Voltage/phase 347/1 (unit sizes 3, 5, 7, 10, and 12 only)
BA6	Internal disconnect switch, lockable, quarter-turn
IC14	Internal tamperproof two-stage thermostat (unit sizes 10, 12, and 15 only)
IC15	Internal tamperproof single-stage thermostat
VFD1	Constant torque ECM motor

Field-Installed Options

Option	Description
HL10	Louver kit, horizontal or vertical
HZ3	Pleated filter
HZ4	Washable filter

Technical Data

Parameter	Unit of Measure	Unit Size (kW)					
		3	5	7	10	12	15
Heating capacity	watt	3100	5000	7500	10,000	12,000	15,000
	BTUh	10,578	17,060	25,591	34,121	40,945	51,182
Temperature rise	°F	22	37	25	32	40	49
	°C	12	21	14	18	22	27
Airflow, low speed	CFM	430			1100		
Airflow, high speed		460			1200		
Fan motor	HP	1/3					
	RPM	1075					

Dimensions

3.1kW and 5kW models

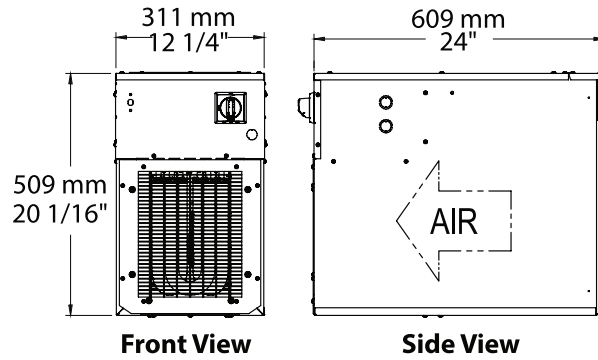

Dimensions for ductwork

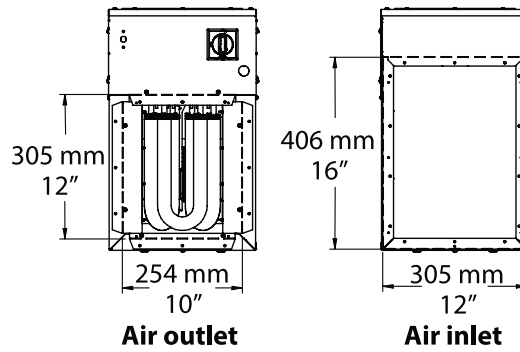

7.5kW to 15kW models

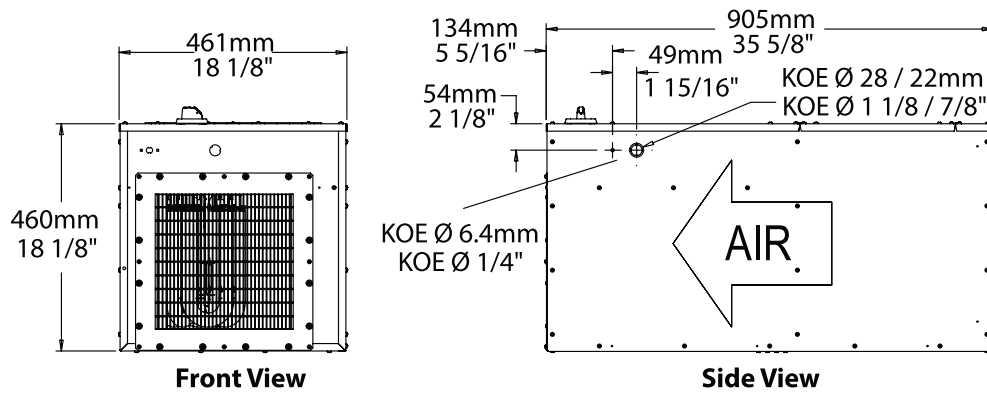

Dimensions for ductwork

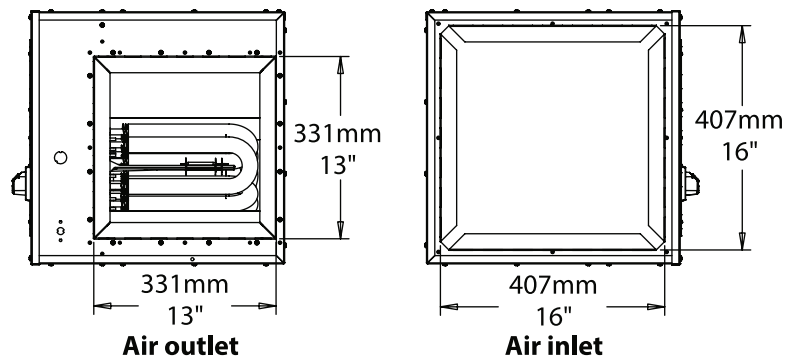

TECHNICAL SPECIFICATIONS—CONTINUED

Weights

Unit Size (kW)			
3, 5		7, 10, 12	15
Voltage			
208, 240, 277	347, 480, 600		
Pounds (kg)			
65 (30)	77 (35)	100 (46)	112 (51)

NOTES

⚠ DANGER ⚠

- This heater has hot parts inside. Do not store or use gasoline or other flammable vapors and liquids in the vicinity of this or any other appliance.
- This heater is hot when in use. To avoid burns, do not let bare skin touch hot surfaces.
- Do not operate any heater after it malfunctions. Disconnect power at the service panel and have the heater inspected by a reputable electrician before reusing.
- Do not use outdoors.
- Do not insert or allow foreign objects to enter any heater opening as this may cause electrical shock, fire, or damage to the heater.
- To prevent a possible fire, do not block air intakes or exhaust in any way whatsoever.
- Use this heater only as recommended by the manufacturer. Any other use may cause electrical shock, fire, or damage to the heater.

For more information on Reznor HVAC products:

- Contact your local Reznor representative at 1-800-695-1901
- Refer to the manuals and additional consumer materials found at www.reznorhvac.com

